

Fountaine Pajot MY4.S



Length Overall:

12,20 m

Beam:

5,15 m

Modelyear:

2022

Engines:

**2 x YANMAR 4LV 250 (2 x 250
HP)**

Cabins:

4

Berths:

8

Heads:

2

Fresh Water Tank Capacity:

350 l

Fuel Tanks Capacity:

2 x 600 l

PRICE:

648.000 €

VAT. Excluded

Equipment

General Equipment: • Antifouling • Transom Door To Bathing Platform • Bathing Ladder
• Bathing Platform • Gangway • Teak on Bathing Platform • Cockpit Table • Foredeck
cushions • Cockpit cushions • Radio • Safe • Loudspeakers In Cockpit

Interior Cabin Layout: • Helm • Saloon • Guest Cabin • Aft Cabin

Electronic Equipment: • Aircondition • Generator • Inverter • Battery • Battery Charger
• Bilge Pump • Searchlight • Shore Supply

Navigation Equipment: • Autopilot • Compass • Depth Sounder • GPS Chartplotter
• Speedometer • VHF Radio

Galley Equipment: • Sink • Refrigerator • Freezer

Bathroom/WC: • Bathroom • Shower • Toilet • Toilet electric • Sink

This very well equipped new Fountaine Pajot MY4.S for sale.

Boat available in stock, visible in Seget Donji/Croatia.

Special equipment:

Gold Version - Package

- 2 Rope cutters
 - Add. windlass control chain counter
 - Cockpit cushions
 - Saloon curtains pleated blinds
 - One fresh water electric head on portside (owner's head)
 - 220V 50HZ main system with cabin outlets
 - Additional AGM battery 115A suppl.
 - Fusion Bluetooth saloon audio pack with 2 Speakers
 - Outdoor foredeck cushions (2)
 - Inside & outside courtesy lighting
 - Hot/cold water on 1 deck shower
 - 12V outlet at helm station
 - 2000W Inverter/charger / 220V 50HZ
-
- Upgrade - 2 YANMAR 4LV 250 engines
 - Bimini for cockpit
 - Cockpit table
 - Handrails on fore deck accesses
 - 220V Kenyon electric grill in cockpit
 - Anchor locker & cockpit freshwater outlet
 - Combination locking safe
 - Mosquito nets for saloon & cabin portholes
 - Hull bed slatted bases for 4 cabins
 - GARMIN Pack 1: Autopilot, VHF, AIS, Garmin 8410, multi GMI20
 - Backward camera
 - GARMIN autopilot remote
 - 12V 130L Fridge
 - Gas oven
 - One guest fresh water electric head
 - Air conditioning 16 000 BTU Quatuor
 - Interior 12V outlet
 - Solar panels 3X90/100W on sport top
 - Generator 8kW
 - Air conditioning shore connection
 - 1 stainless steel davit max.160kg
 - Aft hydraulic platform & natural teak (up to 400kg)
 - Antifouling
 - Searchlight

Informative expose. Errors and changes excepted. Non-binding offer. Subject to prior sale.

Errors and changes excepted.

Top Roof

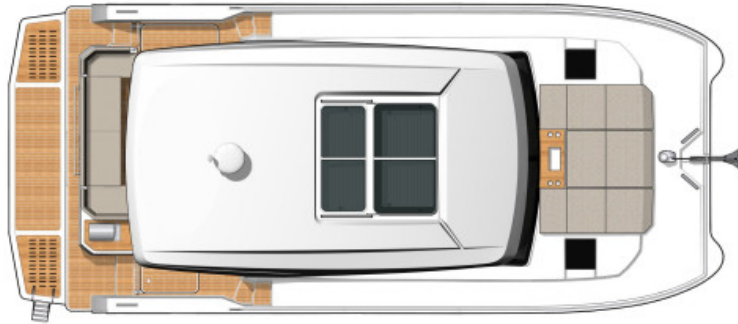

Main Deck

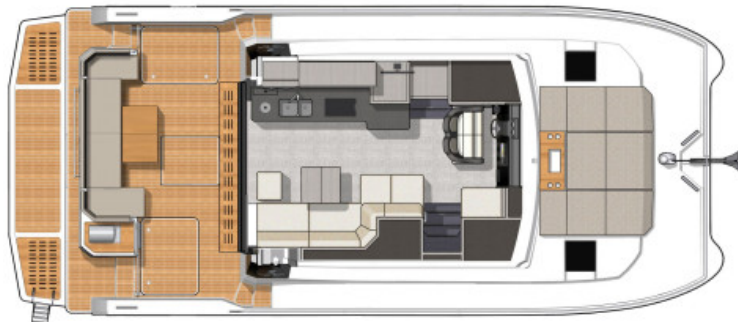

Lower Deck

